

# SHELL END MILL ARBOR

• For clamping shell end mill and milling cutter.

JIS B6339 Form A	Standard G6.3 15,000 RPM
---------------------	-----------------------------------

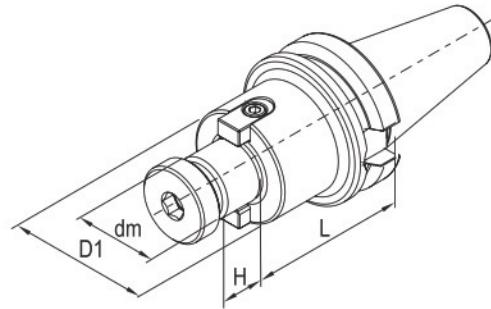

Order No.	Model	Shank	Size(mm)				Screw	Key	Screw
			dm	D1	L	H			
121-07-301	BT30-XMB16-60	BT30-A	16	34	60	17	MS08030	JC08017	MS03008
121-07-302	BT30-XMB22-45	BT30-A	22	42	45	19	MS10030	JC10021	MS04010
121-07-303	BT30-XMB27-45	BT30-A	27	60	45	21	SXM27	JC12023	MS05016
121-07-401	BT40-XMB16-60	BT40-A	16	34	60	17	MS08030	JC08017	MS03008
121-07-402	BT40-XMB16-90	BT40-A	16	34	90	17	MS08030	JC08017	MS03008
121-07-403	BT40-XMB16-120	BT40-A	16	34	120	17	MS08030	JC08017	MS03008
121-07-404	BT40-XMB22-60	BT40-A	22	42	60	19	MS10030	JC10021	MS04010
121-07-405	BT40-XMB22-90	BT40-A	22	42	90	19	MS10030	JC10021	MS04010
121-07-406	BT40-XMB22-120	BT40-A	22	42	120	19	MS10030	JC10021	MS04010
121-07-407	BT40-XMB27-60	BT40-A	27	60	60	21	SXM27	JC12023	MS05016
121-07-408	BT40-XMB27-90	BT40-A	27	60	90	21	SXM27	JC12023	MS05016
121-07-409	BT40-XMB27-120	BT40-A	27	60	120	21	SXM27	JC12023	MS05016
121-07-410	BT40-XMB32-60	BT40-A	32	78	60	24	SXM32	JC14020	MS06020
121-07-411	BT40-XMB40-60	BT40-A	40	89	60	27	SXM40	KXM40	MS08020

Order No.	Model	Shank	Size(mm)					Screw	Key	Screw
			dm	D1	D2	L	H			
121-07-501	BT50-XMB16-60	BT50-A	16	34	-	60	17	MS08030	JC08017	MS03008
121-07-502	BT50-XMB16-90	BT50-A	16	34	-	90	17	MS08030	JC08017	MS03008
121-07-503	BT50-XMB16-120	BT50-A	16	34	-	120	17	MS08030	JC08017	MS03008
121-07-504	BT50-XMB22-60	BT50-A	22	42	-	60	19	MS10030	JC10021	MS04010
121-07-505	BT50-XMB22-90	BT50-A	22	42	-	90	19	MS10030	JC10021	MS04010
121-07-506	BT50-XMB22-120	BT50-A	22	42	-	120	19	MS10030	JC10021	MS04010
121-07-507	BT50-XMB22-150	BT50-A	22	42	60	150	19	MS10030	JC10021	MS04010
121-07-508	BT50-XMB22-200	BT50-A	22	42	60	22	19	MS10030	JC10021	MS04010
121-07-509	BT50-XMB22-250	BT50-A	22	42	60	250	19	MS10030	JC10021	MS04010
121-07-510	BT50-XMB27-60	BT50-A	27	60	-	60	21	SXM27	JC12023	MS05016
121-07-511	BT50-XMB27-90	BT50-A	27	60	-	90	21	SXM27	JC12023	MS05016
121-07-512	BT50-XMB27-120	BT50-A	27	60	-	120	21	SXM27	JC12023	MS05016
121-07-513	BT50-XMB27-150	BT50-A	27	60	75	150	21	SXM27	JC12023	MS05016
121-07-514	BT50-XMB27-200	BT50-A	27	60	75	200	21	SXM27	JC12023	MS05016
121-07-515	BT50-XMB27-250	BT50-A	27	60	75	250	21	SXM27	JC12023	MS05016
121-07-516	BT50-XMB27-300	BT50-A	27	60	75	300	21	SXM27	JC12023	MS05016
121-07-517	BT50-XMB32-60	BT50-A	32	78	-	60	24	SXM32	JC14020	MS06020
121-07-518	BT50-XMB32-90	BT50-A	32	78	-	90	24	SXM32	JC14020	MS06020
121-07-519	BT50-XMB32-120	BT50-A	32	78	-	120	24	SXM32	JC14020	MS06020
121-07-520	BT50-XMB32-150	BT50-A	32	78	-	150	24	SXM32	JC14020	MS06020
121-07-521	BT50-XMB32-200	BT50-A	32	78	-	200	24	SXM32	JC14020	MS06020
121-07-522	BT50-XMB40-60	BT50-A	40	89	-	60	27	SXM40	KXM40	MS08020
121-07-523	BT50-XMB40-90	BT50-A	40	89	-	90	27	SXM40	KXM40	MS08020
121-07-524	BT50-XMB40-120	BT50-A	40	89	-	120	27	SXM40	KXM40	MS08020
121-07-525	BT50-XMB40-150	BT50-A	40	89	-	150	27	SXM40	KXM40	MS08020

